



# **COMPETITION GUIDELINES**

## **CABLE WAKEBOARD & WAKESKATE**

### **Effective from 1st March 2025**

# **Rule book by the Cable Wakeboard World Council of the International Waterski & Wakeboard Federation.**

**To be used in conjunction with the relevant guidance documents.**

## **Table of Contents**

<b>FOREWORD</b>	<b>3</b>
<b>1. GENERAL</b>	<b>3</b>
<b>2. SAFETY AND RIDERS' EQUIPMENT</b>	<b>3</b>
<b>3. COMPETITION ADMINISTRATION</b>	<b>5</b>
3.A COMPETITION COSTS	5
3 B SUGGEST NUMBER OF DAYS REQUIRED FOR A COMPETITION BASED ON COMPETITOR NUMBERS	7
3 C ADDITIONAL CONSIDERATIONS – REQUESTS FROM RIDERS	7
<b>4. OFFICIALS</b>	<b>9</b>
<b>5. START LISTS AND RUNNING ORDER</b>	<b>10</b>
<b>6. FEATURES</b>	<b>11</b>
<b>7. RANKING POINTS</b>	<b>12</b>
<b>8. SEATED CATEGORY SPECIFIC RULES</b>	<b>13</b>
<b>9. VIRTUAL OR ONLINE COMPETITIONS</b>	<b>15</b>
<b>10. ON-SITE REQUIREMENTS - CHECK SHEET</b>	<b>16</b>

## FOREWORD

This document has been created to give detailed descriptions and examples to help users understand the World Rule Book. If for any reason a misunderstanding occurs between this document and the World Rule Book, then the World Rule Book takes precedent, and the CWWC should be notified to rectify the discrepancy.

## 1. GENERAL

- 1.1 Applicability of the Rules:** Where the Rule Book refers to the Chief Judge or Chief Official, this could also be: The Technical Delegate, Competition Manager or Chief Judge. In some instances, this may be the same person.
- 1.2 Doping Control:** All IWWF competitions could be subject to doping control and athletes should be prepared for this. Doping agencies require the athletes' passports at National Championships and all International Events.
- 1.3 Exceptions to Rules:** Will be communicated in advance to athletes giving as much notice as possible. In extenuating circumstances if there is short notice the Chief Official will ensure that these changes are communicated as clearly as possible to the riders using the Competition EMS Page/ Event Commentators and adding in additional Riders Briefings.
- 1.4 Unsportsmanlike Behaviour:** All reports of unsportsmanlike behaviour will be taken seriously. All athletes and team officials need to understand their bad behaviour can also affect their Team Scores at Titled Events and could result in loss of medals.

## 2. SAFETY AND RIDERS' EQUIPMENT

- 2.1** All competitions will be run in-line with the IWWF Safety Manual. If not already included, Cable Wakeboard discipline specific safety guidance will be dealt with within this document.
  - **Link to the IWWF Safety Manual:**  
[https://iwwf.sport/wp-content/uploads/2023/01/IWWF-Safety-Manual\\_rev01\\_20221001.pdf](https://iwwf.sport/wp-content/uploads/2023/01/IWWF-Safety-Manual_rev01_20221001.pdf)
- 2.2 Pre-Competition Safety Form:**

The CWWC require all Organisers to complete a "Pre-Competition Safety Form" as soon as the event is registered in the EMS System. This form must be checked by an experienced CWWC Official, and feedback given to the organiser prior to the CWWC Council (Discipline Administrator) granting approval for the event to go ahead.

  - **Link to Pre-Event Safety Form:** <https://forms.office.com/e/mGcZuhzLJ8>
  - The completed form must be made available to the Chief Official of the event in advance, ideally as soon as nominated to the panel.
  - A competition cannot be approved by the CWWC unless this information is received in full.

**2.3 The Chief Official at the Event:** Will ensure a complete site check is completed before the competition starts ensuring that everything is consistent with the information provided and to ensure they are satisfied with the site.

- **All Features and Anchors:** Must be checked before the competition commences and if event is run over multiple days, at the start of each day. This includes prior to any practice.
  - **Weather:** The weather should be checked at the start of each day and checked for any local weather warnings. Due to the localised nature of the weather, it is acceptable to check this physically on site rather than relying on met office reports. The Chief Judge must only continue a competition if the local weather conditions are consistent with the manufacturer's operating guidelines.
- 2.4** The competition Organiser is responsible for any injuries as a result of the use of the cable and features or any other equipment that would normally be available to the public in the event of an accident.
- 2.5** A suitable First Aid Team, including a Water Rescue Team must be onsite for all CWWC sanctioned competitions. A rescue boat/jetski with a stretcher must be in suitable position to assist injured riders. Pool events are not required to provide a safety boat.
- The stretcher must include the straps and head restraints required for use.
- 2.6** IWWF Concussion Protocol must be adhered to. The Chief Official should appoint the second person to complete the protocol with them – this would ideally be completed by one of the First Aid/Medical Team.

- Links to the Concussion Protocols:

**IWWF Concussion Policy & Protocol:** [https://www.awwf.com.au/wp-content/uploads/2022/01/IWWF-CONCUSSION-POLICY-PROTOCOL\\_20210305.pdf](https://www.awwf.com.au/wp-content/uploads/2022/01/IWWF-CONCUSSION-POLICY-PROTOCOL_20210305.pdf)

**On-Water Concussion Recognition Tool** <https://iwwf.sport/wp-content/uploads/2023/01/IWWF-ON-WATER-CONCUSSION-RECOGNITION-TOOL-OWCRT.pdf>

- 2.7** All athletes ride at their own risk, they are expected to pay attention to any potential site-specific risks and to perform a routine within their abilities.
- 2.8** Riders Personal Equipment – A rider is fully responsible for their personal equipment; it should be fit for purpose and therefore personal equipment may be subject to the approval of the Chief Judge
- Only Wakeboards and WakeSkates will be allowed – Both must float
  - All competitors must wear a Life Vest, it is the responsibility of the rider to ensure their life vest meets the following requirements:
    - It must float the Rider
    - It must be constructed to provide adequate protection from impact damage to the ribs and internal organs.
  - Riders must wear a suitable well fitted helmet in the course. If a rider performs their routine without a helmet, they will be disqualified from the competition.

Discipline	Category	Name	National Competitions			International Competitions							
			National Champs								Int 6 Star		
			Nat 1 Star	Nat 2 Star	Star 3	Int 1 Star	Int 2 Star	Int 3 Star	Int 4 Star	Int 5 Star WT	World Championships	5 Star E&A Confed	5 Star AO/Panam Confed
IWWF Licence Required			NO	NO	YES	NO	NO	YES	YES	YES	YES	YES	YES
Wakeboard	U9	Groms	3	3	3								
	U11	Minis	3	3	3								
	U14	Boys/Girls	3	3	3	3	3	3			6 - 400	6 - 400	6 - 200
	U18	Juniors	3	3	3	3	3	3	3		6 - 800	6 - 800	6 - 400
	OPEN	Open	3	3	3	3	3	3	3	3	6 - 800	6 - 800	6 - 400
	O30	Masters	3	3	3	3	3	3	3		6 - 800	6 - 800	6 - 400
	O40	Veterans	3	3	3	3	3	3			6 - 400	6 - 400	6 - 200
	O50	Legends	3	3	3								
Wakeskate	U14	Boys/Girls	3	3	3								
	U18	Juniors	3	3	3	3	3	3	3		6 - 800	6 - 800	6 - 400
	OPEN	Open	3	3	3	3	3	3	3	3	6 - 800	6 - 800	6 - 400
Seated	U18	Juniors	3	3	3								
	OPEN	Open	2	2	2	2	2	2	2	2	2	2	2

2/3/6 = Number of riders required to open the category

200 / 400 / 800 - Number of Point required to enter the competition

Category not available for competition type

### 3. COMPETITION ADMINISTRATION

**3.1** The above table shows all the competition types that can be run and includes the number of riders required to open the category at the competition. For Confederation and World Championships it also shows the minimum points required by riders to enter the competition.

It is the choice of the Organiser on the categories registered for an event, it is not mandatory to register all categories for all competitions. E.g. It would be feasible for a Federation to register a 2 Star National Event for Just Seniors – Being O30/O40 & O50, or Just an OPEN event etc. The only limitation is that the competitions opened must be available for both Men and Women to compete.

#### 3.A COMPETITION COSTS

##### 3.2 IWWF Licences

- are required by Riders for ALL Competitions 3 Star and above both National and International Events. Riders need to check with their National Federation on how to purchase their IWWF Licence. (Some Federations have Bulk licence agreements with IWWF and purchase the licences directly for the riders, other require the rider to purchase the licence themselves. Riders whose Federation is

not part of IWWF must purchase the Enhanced IWWF Licence to enter the competitions.

### 3.3 REGISTRATION OF EVENTS

- All events must be registered on the IWWF EMS System by the Federations. The table below shows the Registration & Service Fees payable for each competition registered. This will be charged by Invoice to the Federation registering the competitions.
- To encourage growth of the sport, there are no registration fees for independent Seated Events.

<b>NATIONAL EVENTS</b>	<b>1 STAR</b>	<b>2 STAR</b>	<b>3 STAR – Nationals</b>	<b>INV</b>
<b>Ranking Points Awarded</b>	<b>100</b>	<b>200</b>	<b>400</b>	
<b>Registration Fee</b>	<b>€50</b>	<b>€100</b>	<b>No charge</b>	<b>€50 + 1% Prize Fund</b>
<b>Service Fee per Rider per Foreign Official</b>	<b>€5</b>	<b>€5</b>	<b>€5</b>	<b>€5</b>
<b>Minimum Official Training Time (included within the entry fee)</b>	<b>1hr</b>	<b>2hrs</b>	<b>3hrs</b>	<b>2hrs</b>
<b>Minimum Number of Officials for Event</b>	<b>4</b>	<b>5</b>	<b>5</b>	<b>5</b>
<b>Travel and Hotel Costs for Officials</b>	<b>100%</b>			
<b>Drinks and Food for Officials</b>	<b>100%</b>			
<b>Technical Requirements</b>	<b>100%</b>			

There is no requirement for Foreign International Officials at National Events, however if a Foreign Official is required by the Organiser or Federation, then the Service Fee is payable.

<b>INTERNATIONAL EVENTS</b>	<b>1 STAR</b>	<b>2 STAR</b>	<b>3 STAR</b>	<b>4 STAR</b>	<b>5 STAR</b>	<b>INV</b>
<b>Ranking Points Awarded</b>	<b>100</b>	<b>200</b>	<b>400</b>	<b>600</b>	<b>800</b>	
<b>Registration Fee</b>	<b>€100</b>	<b>€200</b>	<b>€300</b>	<b>€400</b>	<b>By negotiation with the CWWC</b>	<b>€50 + 1% Prize Fund</b>
<b>Minimum Prize Fund</b>			<b>€500</b>	<b>€3500</b>	<b>€5000</b>	
<b>Service Fee per Rider per Foreign Official</b>	<b>€5</b>	<b>€5</b>	<b>€5</b>	<b>€5</b>	<b>€5</b>	<b>€5</b>
<b>Minimum Official Training Time (included within the entry fee)</b>	<b>1hr</b>	<b>2hrs</b>	<b>3hrs</b>	<b>4hrs</b>	<b>5hrs</b>	<b>2hrs</b>
<b>Minimum Number of Officials for Event</b>	<b>4</b>	<b>5</b>	<b>5</b>	<b>7</b>	<b>7</b>	<b>5</b>

<b>Minimum Number of Foreign Officials Needed for event</b>	<b>1</b>	<b>1</b>	<b>2</b>	<b>3</b>	<b>3</b>	<b>2</b>
<b>PERFORMANACE GUARANTEE</b>	<b>€100</b>	<b>€200</b>	<b>€800</b>	<b>€1,600</b>	<b>€5,000</b>	<b>€800</b>
<b>Travel and Hotel Costs for Officials</b>	<b>100%</b>					
<b>Drinks and Food for Officials</b>	<b>100%</b>					
<b>Technical Requirements</b>	<b>100%</b>					

***These fees do not apply to TITLED Events, which are negotiated under a separate contract with the relevant council.***

### **In both National and International Competitions, the Cancellation Policy is as follows:**

In the event of cancellation of the event, the organiser promises to reimburse any costs borne by either the IWWF or registered and paid riders to the event. These costs include but are not limited to flights, hotel accommodation, airport transfers, parking fees.

The organiser will also lose the registration fee on cancellation of the event.

If the organiser does not reimburse costs borne, then these costs will be recovered from the authorising Federation.

### **3 B SUGGEST NUMBER OF DAYS REQUIRED FOR A COMPETITION BASED ON COMPETITOR NUMBERS**

Having too many competitors at a competition and short time frame can cause significant stress to all involved. We suggest using the below table when setting the amount of time for your event. If time is a factor when setting your event, it is worth thinking about either capping the overall numbers for your event or opening less categories putting more focus into the OPEN division.

<b>Number of Riders</b>	<b>1-3 Star Event</b>	<b>4 Star Event</b>
<b>Up to 40 Riders</b>	<b>1 DAY</b>	<b>2 DAYS*</b>
<b>Up to 70 Riders</b>	<b>2 DAYS</b>	<b>2 DAYS</b>
<b>Up to 90 Riders</b>	<b>2 DAYS</b>	<b>3 DAYS</b>
<b>Up to 110 Riders</b>	<b>3 DAYS</b>	<b>3 DAYS</b>
<b>Up to 140 Riders</b>	<b>4 DAYS</b>	<b>4 DAYS</b>

Please allow more time if you want to give additional training time. The above table is based on the minimum training hours required.

\*4 Star Events should be a minimum of 2 Days.

### **3 C ADDITIONAL CONSIDERATIONS – REQUESTS FROM RIDERS**

To encourage a good collaborative event between Riders / Organiser and council we are including here the latest request from the Riders Representatives for consideration at all events.

Where possible we would encourage organisers to include as much as possible, all these requirements (except for Free Water on the Start Dock) can be available for additional charge.

- **Training & Practice Time**

- One Month Prior to the event - What are the proposed operating hours for the Cable, and will there be dedicated training sessions for riders to ensure fair preparation before the competition?
  - 3.3...1** Riders need sufficient training time in competition conditions to familiarize themselves with the setup, water conditions, and obstacles.
- Can there be scheduled priority slots for competitors to train without public interference?
  - 3.3...1** This ensures that elite riders can prepare properly without distractions or unsafe conditions caused by other wakeboarders on the course. (Essentially – can there be Public Riding restricted to riders who have entered the event.)
- **Facilities & Rider Comfort**
  - Can you provide a designated warm-up area with suitable facilities, such as physiotherapist, stretching zones, or a small training setup?
    - 3.3...1** Proper warm-up facilities help prevent injuries and allow riders to perform at their best.
  - For events during the inclement seasons, is there a dry, heated area for riders to stay warm and change in case of rain or cold temperatures?
    - 3.3...1** Cold and wet conditions can significantly affect performance and increase injury risks, so having a dry and warm space is crucial for riders' comfort and health.
    - 3.3...2** In Particularly Hot conditions, is there an adequate shading for riders to escape the sun, and or Air-Conditioned Areas to cool down.
  - Will there be secure locker rooms or storage areas where riders can safely keep their gear between runs?
    - 3.3...1** Riders have expensive and essential equipment that needs to be stored securely to avoid loss or damage.
- **Health & Nutrition**
  - Are you able to provide access to healthy food options that cater to athletes' nutritional needs?
    - 3.3...1** Proper nutrition is vital for maintaining energy levels, recovery, and peak performance throughout the competition.
  - Will there be access to hydration stations with clean drinking water near the dock and warm-up areas?
    - 3.3...1** Staying hydrated is essential, and easy access to water prevents dehydration, especially during long competition days.
    - 3.3...2** Free access to Water is required on the Starting Docks – To ensure sustainability - this should be drinking water quality taps, and we should encourage riders to use re-usable water bottles.



- **Competition & Inclusivity**

- What are your plans for prize money in the Open Category, and will there be equal prize distribution for men and women beyond the podium? (IWWF Rules already require a minimum of Equal Podium Prize Money)

**3.3...1** Fair prize money recognizes athletes' dedication and professionalism, ensuring the sport remains financially viable for top competitors.

**3.3...2** Please publish your Prize Fund Distribution with the Competition Bulletin. This should include the distribution across each discipline and not just the total Prize Fund.

- What pick-up opportunities will be available for seated (adaptive) riders to ensure smooth and safe competition for all?

**3.3...1** Seated riders require adapted retrieval methods to minimize downtime and ensure fair participation.

- **Event Organization & Logistics**

- How will communication between organizers, riders, and team representatives be handled to ensure smooth event operations?

**3.3...1** Clear communication prevents confusion and allows riders to focus on their performance rather than logistical issues.

- Will there be a designated media zone where riders can interact with press and sponsors after their runs?

**3.3...1** Media exposure is important for promoting the sport and supporting riders' careers, so a well-organized area for interviews and content creation is beneficial.

- Will there be designated transportation or shuttle services for riders and their equipment between accommodation, the event site, and other key locations?

**3.3...1** Carrying wakeboards and gear can be challenging, and reliable transport options can make logistics easier for riders.

## 4. OFFICIALS

**4.1** All Officials for International Competitions will be appointed by the respective Confederation Council who will look for a balanced and diverse panel. If organisers/federations have preferred choices for Officials, then they can ask for the council to take this into consideration, but the final decision lies with the IWWF Council.

**4.2** Officials for National competitions are appointed by their Federation, there is no requirement for Foreign International Officials at National Events, however if a Foreign Official is required by the Organiser or Federation, then the Service Fee is payable, and allowances will be paid per Official.

- 4.3** All Officials should apply to Officiate at a competition through the IWWF EMS System including an estimate of costs to attend the event, and full availability for the event. The EMS Administrator will then access the EMS System and approve the panel once approval has been gained from the relevant Confederation Council.
- 4.4** All Officials are ambassadors for the IWWF and must follow the IWWF Cable Wakeboard Officials Guide.

## 5. START LISTS AND RUNNING ORDER

Whilst the IWWF Scoring System (SCORE NOW) will automatically generate the Start lists and running order for the events, it is essential that the Scorer and Chief Judge at the event understand the principle for creating in the event of a systems failure during the event.

As per the Rule Book, disagreements with the system generated start lists and running orders is no grounds for a protest and will not delay the running of a competition.

There are 3 systems used to create the Starting lists. These are detailed in the Scoring and Heat Systems Document.

Round 1 - Results

Snake System

Placement	Group A	Group B	Group C
1	Athlete 1	Athlete 2	Athlete 3
2	Athlete 4	Athlete 5	Athlete 6
3	Athlete 7	Athlete 8	Athlete 9
4	Athlete 10	Athlete 11	Athlete 12
5	Athlete 13	Athlete 14	Athlete 15
6	Athlete 16	Athlete 17	Athlete 18

Ladder System

Placement	Group A	Group B	Group C
1	Athlete 1	Athlete 2	Athlete 3
2	Athlete 4	Athlete 5	Athlete 6
3	Athlete 7	Athlete 8	Athlete 9
4	Athlete 10	Athlete 11	Athlete 12
5	Athlete 13	Athlete 14	Athlete 15
6	Athlete 16	Athlete 17	Athlete 18

Stepladder System (AAL)

Placement	Group A	Group B	Group C
1	Athlete 1	Athlete 2	Athlete 3
2	Athlete 4	Athlete 5	Athlete 6
3	Athlete 7	Athlete 8	Athlete 9
4	Athlete 10	Athlete 11	Athlete 12
5	Athlete 13	Athlete 14	Athlete 15
6	Athlete 16	Athlete 17	Athlete 18

Round 2 - Startlists

Startingorder	Group A
1	Athlete 7
2	Athlete 8
3	Athlete 9
4	Athlete 6
5	Athlete 5
6	Athlete 4
7	Athlete 1
8	Athlete 2
9	Athlete 3

Startingorder	Group A
1	Athlete 7
2	Athlete 8
3	Athlete 9
4	Athlete 4
5	Athlete 5
6	Athlete 6
7	Athlete 1
8	Athlete 2
9	Athlete 3

Startingorder	Group A
1	Athlete 8
2	Athlete 9
3	Athlete 7
4	Athlete 6
5	Athlete 4
6	Athlete 5
7	Athlete 1
8	Athlete 2
9	Athlete 3

Will be used for all Qualification startlists

Will be used for all x > 1 group options, mainly finals.

Will be used for all MOD2 group options, mainly LCQ, Quarter and Semis.

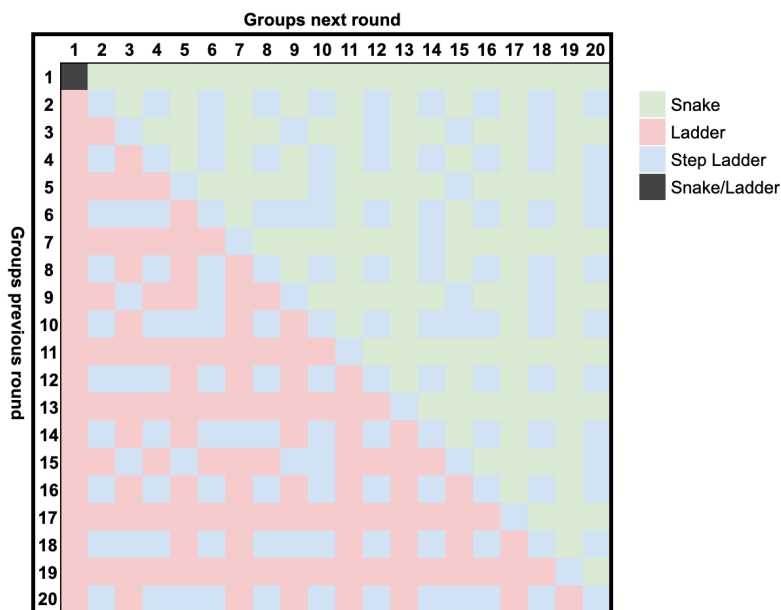

## 6. FEATURES

Taken from Point 2 of the rule book.

2.2 The Chief Official at the event (Either - Technical Delegate / Competition Manager/ Chief Judge) and CWWC Official will check the entire site to ensure the competition can be carried out as safely as possible, especially when the site is built specifically for the competition.

2.3 The Chief Judge must check all features before the official training or nominate a suitable official to do this.

2.4 The competition organiser is responsible for any injuries as a result of the use of the cable and the features or any other equipment that would normally be available to the public in the event of an accident.

Example of a feature that cannot be used in both directions. Vertical areas facing the rider have to be avoided (in red).

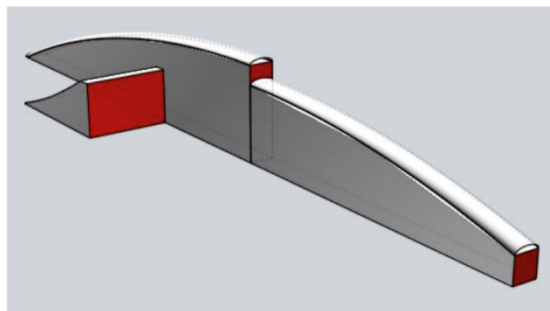

Example of a feature that can be used in both directions.

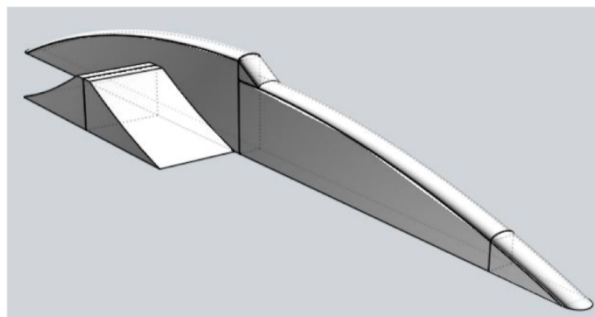

### Corrugated Pipes

The use of corrugated pipes as a sliding surface poses significant risks. Depending on their depth, each rib becomes a structural and permanent point of impact. Catching the heelside, toeside, molded fins and fins can happen at any time and cause the board to come to an abrupt stop, and the associated fall of the rider on the pipe. Due to the momentum of the rider, there is not only an impact between the body and the pipe, but also a hit on each rib of the corrugated pipe which can quickly increase the severity of the fall.

The three leading manufacturers don't use this type of material in their current ranges of features for these safety reasons.

The International Cable Wakeboard World Council (CWWC) advises strongly against the production and use of features using such pipes as sliding surfaces during public hours. It could be allowed at events and competitions, depending on the condition of the pipe and the competition field, if a special briefing is included at the Riders Meeting before the competition.

## 7. RANKING POINTS

	*****	*****	****	***	**	*
	6STAR	5STAR	4STAR	3STAR	2STAR	1STAR
1	1000	800	600	400	200	100
2	925	740	555	370	185	93
3	856	685	513	342	171	86
4	791	633	475	317	158	79
5	732	586	439	293	146	73
6	677	542	406	271	135	68
7	626	501	376	251	125	63
8	579	464	348	232	116	58
9	536	429	322	214	107	54
10	496	397	297	198	99	50
11	459	367	275	183	92	46
12	424	339	255	170	85	42
13	392	314	235	157	78	39
14	363	290	218	145	73	36
15	336	269	201	134	67	34
16	311	248	186	124	62	31
17	287	230	172	115	57	29
18	266	213	159	106	53	27
19	246	197	147	98	49	25
20	227	182	136	91	45	23
21	210	168	126	84	42	21
22	195	156	117	78	39	19
23	180	144	108	72	36	18
24	166	133	100	67	33	17
25	154	123	92	62	31	15
26	142	114	85	57	28	14
27	132	105	79	53	26	13
28	122	97	73	49	24	12
29	113	90	68	45	23	11
30	104	83	63	42	21	10
31	96	77	58	39	19	10
32	89	71	54	36	18	9
33	83	66	50	33	17	8
34	76	61	46	31	15	8
35	71	56	42	28	14	7
36	65	52	39	26	13	7
37	60	48	36	24	12	6
38	56	45	34	22	11	6
39	52	41	31	21	10	5
40	48	38	29	19	10	5
41	44	35	27	18	9	4
42	41	33	25	16	8	4
43	38	30	23	15	8	4
44	35	28	21	14	7	4
45	32	26	19	13	6	3
46	30	24	18	12	6	3
47	28	22	17	11	6	3
48	26	20	15	10	5	3
49	24	19	14	9	5	2
50	22	18	13	9	4	2

## 8. SEATED CATEGORY SPECIFIC RULES

### 2. SAFETY AND RIDERS' EQUIPMENT

**2.9** Only wakeboards and kneeboards will be allowed. Both must float.

### 3. ENTRY REQUIREMENTS FOR CONFEDERATION OR WORLD CHAMPIONSHIPS

**3.2** There is no minimum points requirement for the Seated category

### 4. CATEGORIES / DIVISIONS

Open Seated: No age restriction

To open the 'Seated' category at a Titled event, a minimum of 2 riders from 2 different nationalities is required. A minimum of 2 riders from each gender from 2 different Nationalities is required to split the category into Men and Women.

For all other events there must be at least two riders to open the category. To open both Men and Women categories, there must be at least two riders in each.

### 9. FEATURES

For seated categories, features without entrance (where an ollie is required) will be forbidden.

### 11. JUDGING CRITERIA / SCORING

Specific ratio is applied for the scoring of seated category.

The final score will be altered (multiplied) with the rider's category ratio to give his/her final score.

Category	Ratio
MP1	2.0
MP2	1.6
MP3	1.3
MP4	1.2
MP5	1.0

**MP1 Riders:** No controlled trunk movement (unsupported) in all planes. Little or no balance in both forward and sideways directions. Balance and movement are significantly impaired. Skier is unable to hold or maintain holding the handle with hands. Skiers have no trunk rotation and no use of abdominal muscles. Skiers in this class generally have complete tetraplegia/quadriplegia, although skiers with other diagnoses may qualify in this category.

**MP2 Riders:** Little or no controlled trunk movement in all planes. Balance in both forward and sideways directions significantly impaired and Riders rely on their arms to return them to the upright position when unbalanced. No active trunk rotation and no use of abdominal muscles. Riders in this class are generally quadriplegics, may be incomplete quadriplegics with more

functional ability and high level paraplegics, although other diagnoses may qualify in this category.

MP3 Riders: Some partially controlled trunk movement in the forward direction, but little or no controlled sideways movement, has upper trunk rotation but poor lower trunk rotation. Riders in this category are generally mid-level break paraplegics, although Riders with other diagnoses may qualify in this category.

MP4 Riders: Good trunk movement in the forward direction to his/her knees and up again without arm support. Has good trunk rotation but limited controlled sideways movement. Riders in this category are generally lower level break paraplegics, although Riders with other diagnoses may qualify in this category.

MP5 Riders: Normal trunk movement in all directions, able to reach side to side with no limitations. Able to move hips independently. Riders in this category are generally amputees who cannot ski standing, Riders with low or incomplete spinal cord injuries with leg control and Riders with required minimum disability and who display controlled sideways (hip) movement.

Qualification criteria: only riders with a form of disability that fall under the noted categories are allowed to compete in the seated category.

## 9. VIRTUAL OR ONLINE COMPETITIONS

1. All events will be registered at [cablewakeboard.net](http://cablewakeboard.net) and riders will join them in order to get the final scores & ranking points.
2. Unedited videos will be uploaded to the online platform.-Please mind, unedited means tricks have to be unedited (no slow motions as well), one camera for one trick, the whole trick must be clearly shown in the video, including the approach and landing. You can add sponsors to the beginning, add or edit the title and combine different footage for different tricks, or add the slow motions to the end of the video.
3. For categories of max. 18 riders there will be no heats and no LCQ's. For +18 riders standard heat system will be used.
4. Virtual / Online competitions are differentiated as:

### LOCATION BASED EVENTS

The approved rank of these competitions will highly depend on the travel restrictions (at this point only National events will be approved).

All local Pandemic regulations must be adhered to throughout the event.

There will be no Official practice, riders can practise during the public hours.

Organizer will ensure min. 1 hour per day for competition runs, clearly stated in the Bulletin.

If organizer requires so, riders have to book and pay the fees in advance.

The course will be in place two weeks before the start of the event.

Three riders are required to open the category.

All riders will get 2 runs for the competition, and will choose which run to upload for judging.

A dedicated Dock and Video Officials will be provided by the organizer.

All videos must be raw footage, no editing allowed, using the same camera angles for all participants. Videos will be uploaded within 12hrs of competition run taking place.

For the National Championships, the Confederation Council will appoint an independent Supervisor to ensure the rules are followed.

### NON-LOCATION BASED EVENTS

Organizers are welcome to surprise us with new exciting formats, riders will shoot and upload the videos themselves.

5. Organizers will compile the Competition Bulletin containing the following information:
  - Competition format explained in detail
  - Requested Rank of the event (1-4 stars, ranked, non-ranked), categories
  - Registration rules, fees and deadlines, duration of the event
  - Prizes
  - Judging criteria, including community judging (max. 10%)
6. Bulletins for proposed International events will be revised by CWWC, for National events by the relevant Confederation Councils and Judging panel will be appointed.
7. Competitions will be awarded the appropriate Rank depending on format, Prize fund, competition duration and on-site Officials.
8. Final results will be published and confirmed no later than 24 hours after the competition closes online, details of each event to be listed in the bulletin.

## 10. On-site Requirements - Check sheet

Check List	YES/NO
Official Team, all present	
Cable Operators for duration of competition	
Jetty Marshall	
Commentator	
Safety & Medical Crew	
Cable Technician to take care of equipment	
Refreshments for Officials	
Bibs checked and available for registration	
<b>Physical Checks</b>	
Cable Course Start and End Markers in place.	
Cable Check – Carrier system check for time calculation	
Features Check	
Safety Boat with Crew (Min 2 People)	
Safety Boat fuel – Enough for whole day	
Safety Boat Kill Switch	
Life vests for safety Crew	
Spinal Board with head restraint and straps available	
On-Site Medical Team in place	
Walkie Talkie Radios for Officials	
<b>Start Dock</b>	
Start Area Clear for riders and ready to use	
Jetty Marshall start lists printed & Ready on clipboard	
Restricted access to Start Dock	
Stopwatch/Timer available for timing equipment repairs or non-starters (can be mobile phone)	
Basic tools for repairs on start dock. (Allen key, screw driver, cable ties, duct tape)	
Is there a Dock TV (Ipad/Screen for Live Results and Start Lists)	
<b>Commentators Equipment</b>	
Sound System with 2 microphones (Ideally cordless)	
Printed Start list sheets for commentators on clipboard	
If livestream at event, link to commentators	
Does location of commentators allow them to access a view of the live results	
Does commentator have a list of all sponsors to thank for the event	
<b>Judges Tent</b>	
Power for scorers laptop/ipad and Judges phones if using for scorenow.	
Table with enough room for all Judges and scorer	
Clipboards for all judges and shadow judges	
Positioned away from riders and spectators to allow free discussions	
Rubbish bag for keeping area clean	
Good Internet Connection – to allow live results to be input into Scorenow	
<b>Office</b>	
Is there an area/office we can access – this does not have to be a dedicated office for our use.	
Printer for commentators/dock marshalls start lists & Judges sheets – CHECK INK LEVELS	



Paper for printing above sheets (No Results should be printed, as these can all be accessed online)	
Good Internet Connection – to allow access to scoring system to print	
<b>Riders &amp; Team Captains</b>	
Is there a secure area for Riders Equipment	
Are there any restricted areas just for riders	
Are refreshments available on site	
Free Water available for riders at the start dock	
Is there a physio available for riders	
<b>Prize Giving Ceremonies</b>	
Have all Medals been checked	
Is there a backdrop for Prize Ceremony	
Are country flags available	
Please check details of any Prize Fund and how it will be distributed	
Are there any prize bags	
Is there a person responsible for co-ordinating the Prize giving	
<b>General</b>	
Is there a room/area available for Riders & Team Captains Meetings	
Good Internet Connection – to allow riders and spectators access to livestream/results	
Is there a room/covered area available for Riders Registration	